

# AZLA'S SUBMARINE OUTFALL, TETOUAN – MOROCCO

3.124 m long outfall in HDPE Ø 1.200 mm,  
diffuser at -37.50 CD



**ETERMAR**

CLIENT

**AMENDIS** – Société des Eaux et d'Electricité du Nord, S.A.





### CONSTRUCTION TIME

19 MONTHS

### DESCRIPTION

Design and build of a 3.124 m long submarine outfall in HDPE pipe Ø 1.200 mm including the following works:

- Trench opening in land and sea for pipe installation;
- Supply, assembly and placement of the pipe;
- Pipe protection;
- Cathodic protection of the pipe;
- Installation of a signaling buoy;
- Cleaning chamber.

The HDPE pipe was produced in Norway, towed to Tanger Med port for preparation, (assembly of concrete ballast blocks and diffuser pipes).

The diffuser consists in 11 pipes with 250 mm of diameter spaced 12 m between them, placed at the maximum depth of -37.50 CD.

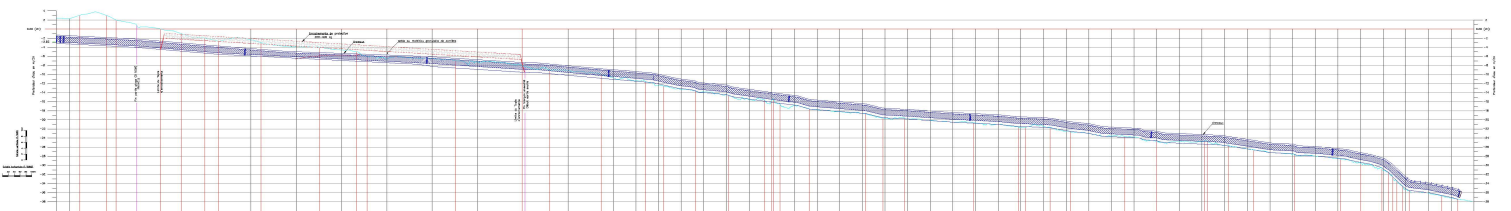

# ETERMAR